

**NOTE:-**  
 \* THIS DRAWING MAY CHANGE AS PER SITE CONDITION.  
 \* ALL THE DIMENSIONS ARE IN MM.  
 \* THE LAYOUT OF THE BUILDING SHALL BE INDICATED AS PER THE CO-ORDINATE MEASUREMENT WITH RELATION TO THE PLOT BOUNDARY.  
 \* FOR DETAIL OF ROOF BEAM, SLAB, PUNCHED BEAM REFER STEEL DWG.  
 \* FOR DETAIL SPECIFICATION REFER B.O.Q.

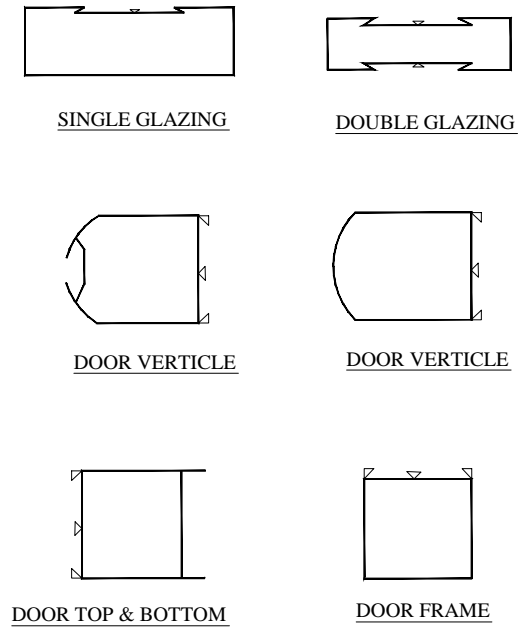

DOOR (D)  
 SIZE: 1800X2175(Including Chowkath)  
 TYPE : DOUBLE LEAF GLAZED DOOR  
 FRONT ELEVATION

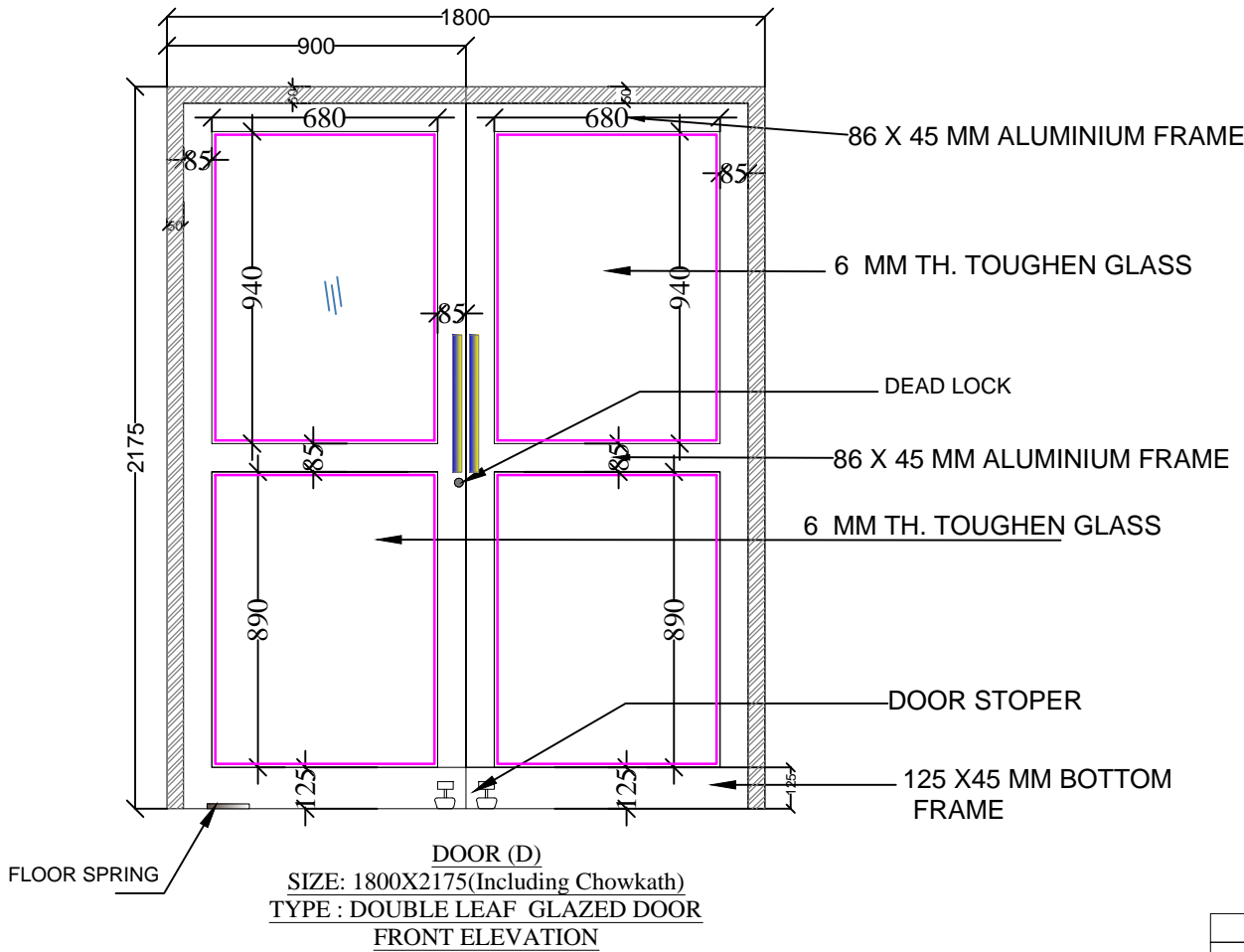
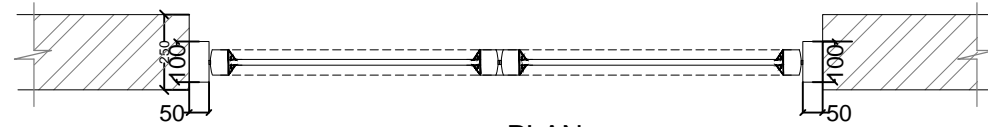

PLAN  
 DOOR (D) 1800X2175

SCHEDULE OF SECTION FOR DOOR			
TYPE	SINGLE GLAZING	DOOR VERTICLE	DOORTOP & BOTTOM
SECTION NO.	5925	5925	5934
WEIGHT	2.340 KG/M.	2.340 KG/M.	2.502 KG/M.
TYPE	DOUBLE GLAZING	DOOR VERTICLE	DOOR FRAME
SECTION NO.	5932	5833	5862A
WEIGHT	2.412 KG/M.	0.600 KG/M.	0.575 KG/M.

REMARKS SIGNATURE

1			
2			
3			
4			
5			
6			
7			
8			
9			
10			

DETAIL OF DOOR (D)

DATE	SCALE	W/S
11/01/2018	1:10	MR. M. RATH
BY	CHECKED	DATE
MR. M. RATH	MR. M. RATH	11/01/2018

NATIONAL LAW UNIVERSITY, ORISSA  
 PROJECT DIRECTOR

PROJECT MANAGEMENT CONSULTANT

DESIGN & DRAWN BY: MANONJAY RATH

CONSULTANT: MANONJAY RATH ARCHITECTURE AND ENGINEERING CONSULTANTS

RELEASED FOR: CONCEPTUAL, TENDER, INFORMATION, APPROVAL, CONSTRUCTION